

# Toyota OBD speed lock manual

## Functions:

### 1. Lock: 15km/h

When car reaches to 15KM/H, automatically Lock the door.(or when you hang "D" gear, auto lock)

### 2. Unlock: when turn off ACC

When you turn off ACC, automatically unlock the door. (or when you hang "P" gear, auto unlock)

### 3. Open door, flash light:

When any one door is opened, lights will be flashing at the same time.

### 4. Distress (eg collision) unlock and flash light:

When car is in Speed plummeted (within 2 seconds from 50KM to 0KM), lights will flash. When car is in Speed plummeted (within 1.5 seconds from 50KM to 0KM), automatically unlock the door.

### 5. When reverse, flash light:

When you hang "R" gear , light will flash, improve safety.

### 6. Cycle lock.

## Speed lock function reset or cancel method: (All should be finished in 30 minutes.)

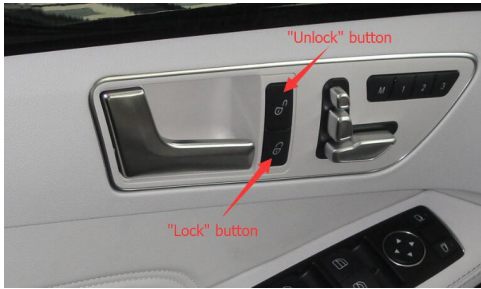

### 1.How to turn off "open door, auto flash light" function:

Pull out OBD> Plug in OBD >Start car engine(Close all doors)> Wait 5 seconds>press (UNLOCK –UNLOCK –LOCK-LOCK –UNLOCK –UNLOCK) in 6 seconds. Light flashing once means turn OFF , flashing twice means turn ON.

### 2.How to turn off "When reverse, flash light" function:

Pull out OBD> Plug in OBD >Start car engine(Close all doors)> Wait 5 seconds>press (UNLOCK –UNLOCK –LOCK-UNLOCK –UNLOCK –LOCK) in 6 seconds. Light flashing once means turn OFF, flashing twice means turn ON.

### 3.How to turn off "Distress (eg collision) unlock and flash light" function:

Pull out OBD> Plug in OBD >Start car engine(Close all doors)> Wait 5 seconds>press (UNLOCK –UNLOCK –UNLOCK- UNLOCK –LOCK –LOCK) in 6 seconds. Light flashing once means turn OFF, flashing twice means turn ON.

## How to install the OBD speed lock?

